

# FRANKLIN HIGH SCHOOL



**COMMUNITY DESIGN WORKSHOP  
SEPTEMBER 21, 2013**

# AGENDA

## PPS INTRODUCTION 9 AM

- WELCOME
- LOGISTICS

## BACKGROUND & CONTEXT 9:15 AM

- AGENDA REVIEW
- PROJECT TIMELINE & PROCESS
- VISION & GUIDING PRINCIPLES
- SUSTAINABILITY KEY THEMES

## HISTORY OF FRANKLIN 9:45 AM

- REVIEW HISTORY OF FRANKLIN DESIGN
- HISTORICAL SIGNIFICANCE REVIEW
- PRIORITIZATION EXERCISE OF CULTURALLY SIGNIFICANT ELEMENTS

## 21ST CENTURY TEACHING & LEARNING ENVIRONMENTS 10:30 AM

## MASTER PLANNING EXERCISE 10:45 AM

- SMALL GROUP EXERCISE
- REPORT BACK
- VOTING EXERCISE

## CONCLUSIONS & NEXT STEPS 11:45 AM

- KEY TAKEAWAYS
- NEXT STEPS:

**COMMUNITY DESIGN WORKSHOP**

**SATURDAY, OCTOBER 12, 2013 9-NOON**



Dull Olson Weekes – IBI Group Architects  
Portland Public Schools – Franklin HS Modernization

21<sup>st</sup> Century Learning in an Historic Building  
September 21, 2013

SERA

# PROJECT TIMELINE & PROCESS

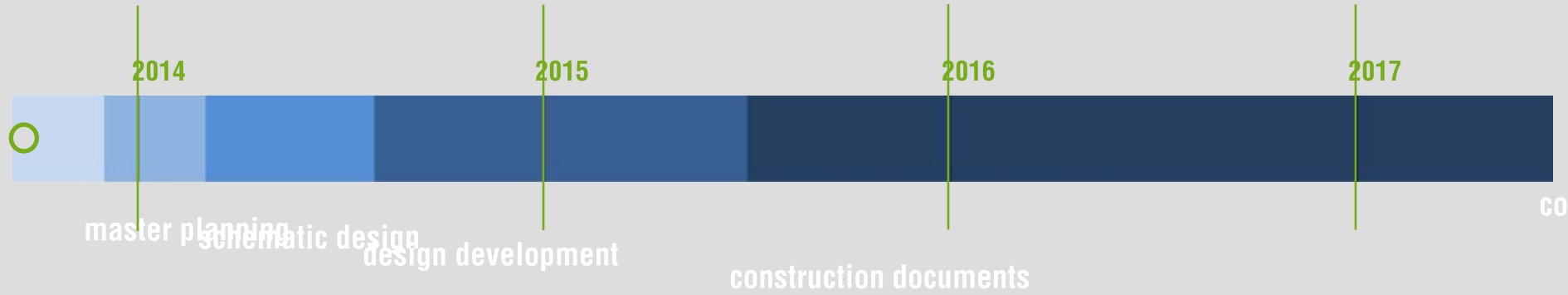

Dull Olson Weekes – IBI Group Architects  
Portland Public Schools – Franklin HS Modernization

21<sup>st</sup> Century Learning in an Historic Building  
September 21, 2013



# PPS VISIONING KEY THEMES

## TEACHING AND LEARNING

- EVERY SCHOOL WILL NURTURE CHILDREN'S INNATE CURIOSITY AND HELP THEM DISCOVER AND SUSTAIN WHAT MOTIVATES THEM TO LEARN.
- EVERY SCHOOL WILL FOCUS ON GIVING STUDENTS THE SKILLS THEY NEED TO BE INDEPENDENT & SELF-DIRECTED LEARNERS.
- THE DISTRICT WILL ENSURE ALL STUDENTS HAVE EQUITABLE OPPORTUNITIES TO SUCCEED & THAT RESOURCES ARE THERE TO MEET THEIR UNIQUE NEEDS.

## LEARNING ENVIRONMENTS

- EVERY SCHOOL WILL BE AN INSPIRATION TO ITS STUDENTS, STAFF & COMMUNITY – A VIBRANT & EXCITING PLACE THAT CELEBRATES GROWTH & LEARNING
- EVERY SCHOOL WILL FOSTER THE PERSONAL RELATIONSHIPS CRITICAL TO EFFECTIVE TEACHING & LEARNING BY ENCOURAGING SOCIAL INTERACTION, AS WELL AS COLLABORATION, AMONG & BETWEEN STUDENTS, STAFF & PARENTS
- EVERY BUILDINGS WILL ENABLE TEACHERS TO PROVIDE A WIDE RANGE OF ENGAGING & EFFECTIVE LEARNING EXPERIENCES & ENABLE THE SCHOOL TO ADAPT TO FUTURE CHANGES IN INSTRUCTIONAL PRACTICE.

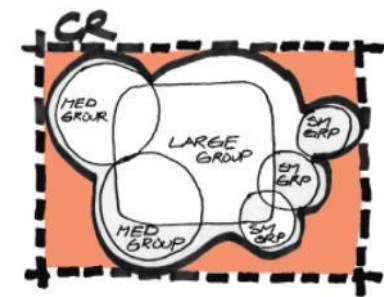
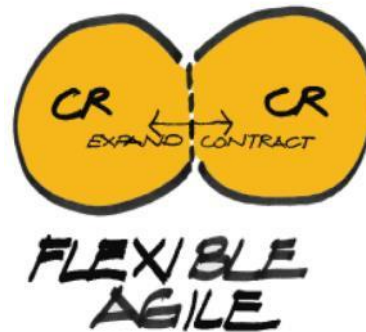
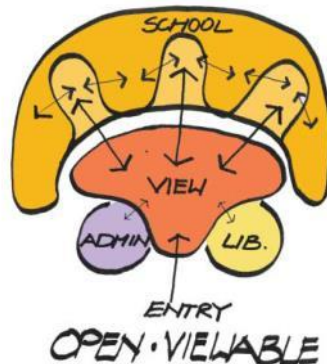
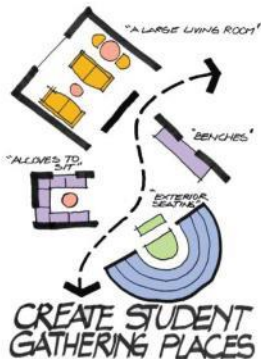

## SCHOOL AND COMMUNITY

- EVERY SCHOOL WILL BE THE CENTER OF ITS NEIGHBORHOOD, WELCOMING PEOPLE OF ALL AGES FOR ACTIVITIES THAT REFLECT LOCAL CULTURES, NEEDS & INTERESTS; AND THAT CONTRIBUTE TO AN EXPANDED LEARNING COMMUNITY THAT ENRICHES BOTH THE SCHOOL & THE CITY.
- EVERY SCHOOL WILL OPEN ITS DOORS TO THE MYRIAD LEARNING OPPORTUNITIES OUR CITY OFFERS INVITING PEOPLE IN TO SHARE WHAT THEY KNOW & SENDING STUDENTS OUT TO LEARN BEYOND THE WALLS OF OUR SCHOOLS.
- EVERY SCHOOL WILL SUPPORT COMMUNITY PARTNERSHIPS THAT PROVIDE & SUPPORT THE SERVICES STUDENTS & FAMILIES NEED FOR EXPANDED LEARNING OPPORTUNITIES AND ENSURING THE HEALTH & SAFETY OF OUR STUDENTS

## FACILITIES SUPPORT

- EVERY SCHOOL WILL BE A BEACON FOR ITS NEIGHBORHOOD, WHERE INTEGRATED OPERATIONAL SYSTEMS SUPPORT A WELCOMING ENVIRONMENT & DYNAMIC LEARNING EXPERIENCES
- EVERY OPERATIONAL SUPPORT SYSTEM WILL CONTRIBUTE TO SAFEGUARDING THE HEALTH & SAFETY OF THE STUDENTS & ADULTS IN THE SCHOOL.
- DESIGN, SYSTEMS CHOICES AND MATERIAL SELECTION WILL PROVIDE A HEALTHY ENVIRONMENT AND ENABLE SUSTAINABLE OPERATIONS & EFFICIENT MAINTENANCE, ENSURING COST-SAVINGS OVER THE BUILDING'S LIFE.

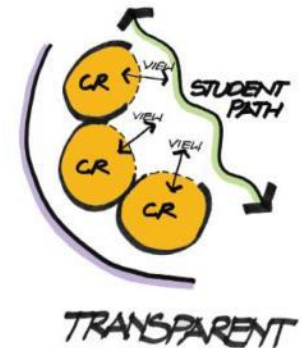
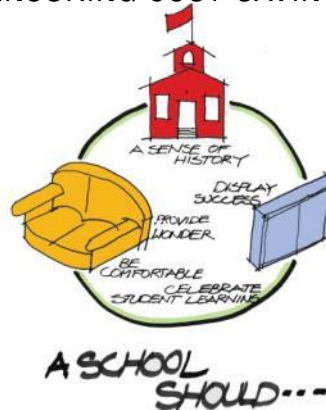
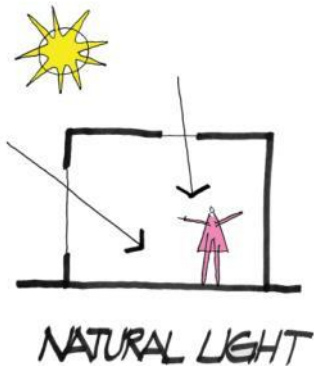
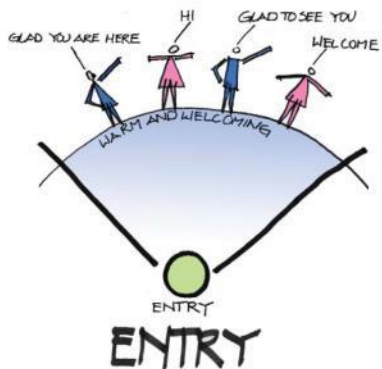

# PROJECT EVALUATION CRITERIA

Operations and maintenance / durability

Operations and maintenance / cost over time

Wise use of bond resources to deliver goals

Resource efficiency (energy, water, etc.)

How systems contribute as 21<sup>st</sup> century teaching and learning tools

Human health and comfort

Preserving existing historic building asset

Acoustics

Aesthetics (general)



# HISTORIC DESIGN OVERVIEW



Dull Olson Weekes – IBI Group Architects  
Portland Public Schools – Franklin HS Modernization

21<sup>st</sup> Century Learning in an Historic Building  
September 21, 2013





Dull Olson Weekes – IBI Group Architects  
Portland Public Schools – Franklin HS Modernization

21<sup>st</sup> Century Learning in an Historic Building  
September 21, 2013





# FRANKLIN HS CAMPUS – INVENTORY

## Franklin High School

5405 SE Woodward St, Portland OR, 97206

[View Site in Google Maps](#)

### Building Periods

1. Original Building (215A), 1915
2. Boiler Building (215D), 1915
3. Gymnasium Building (215B), 1916 (remodeled to classrooms in 1986)
4. Auditorium Addition (215C), 1924
5. Field House, 1950
6. Classroom Wing (215D), 1950
7. Connecting Addition (215C), 1954
8. Gymnasium (215E), 1954
9. Shop Building (215F), 1970



1910s architectural rendering of Franklin High School, designed by Floyd A. Naramore.



1915 photograph during construction of Franklin High School, looking north.

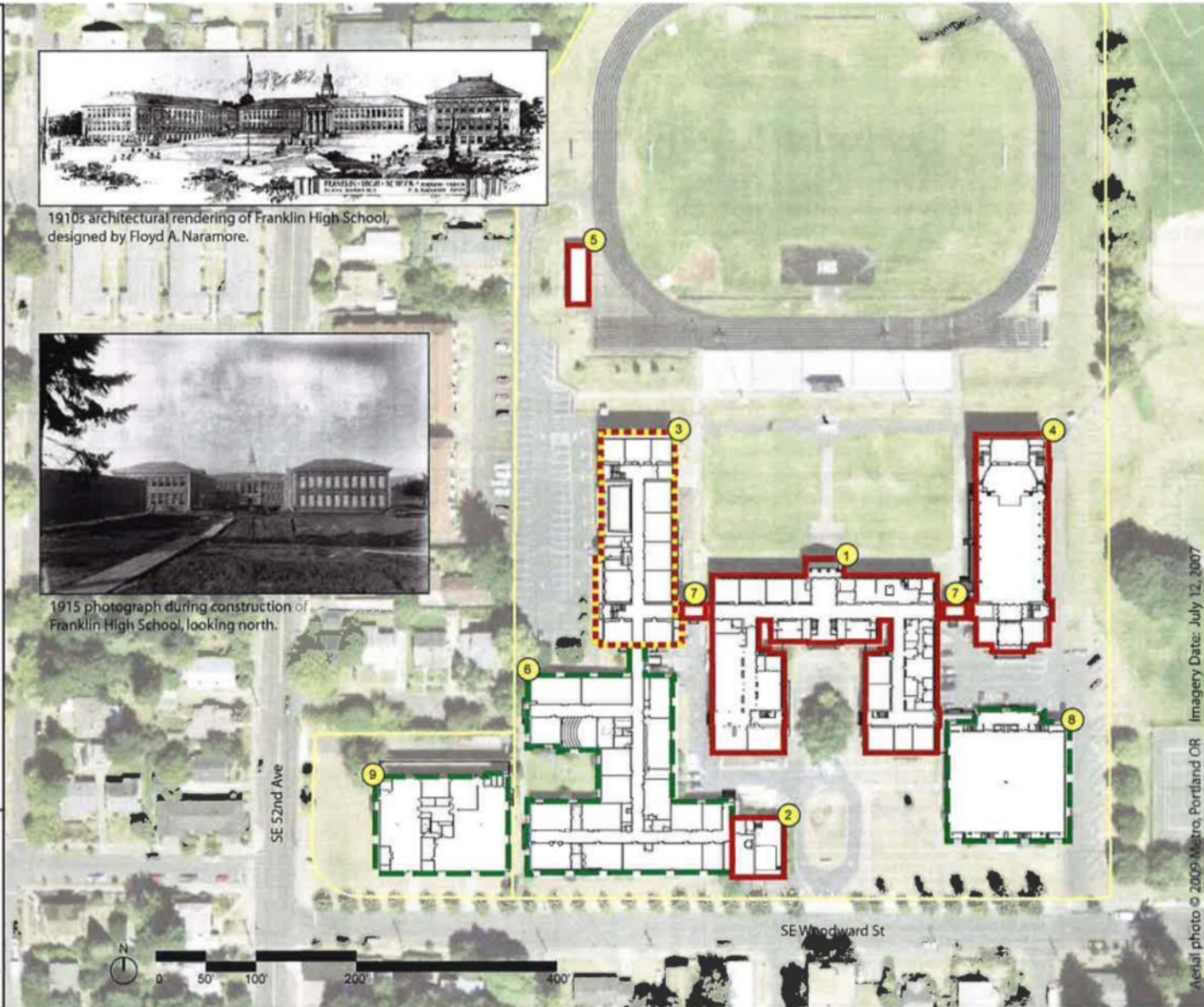

Aerial photo © 2009 Micro, Portland OR Imagery Date: July 12, 2007



### Historical Significance and Building Integrity

- Contributing High Significance
- Contributing Moderate Signif.
- Non-Contributing



Dull Olson Weekes – IBI Group Architects  
Portland Public Schools – Franklin HS Modernization

21<sup>st</sup> Century Learning in an Historic Building  
September 21, 2013



# FRANKLIN HS CAMPUS – INVENTORY

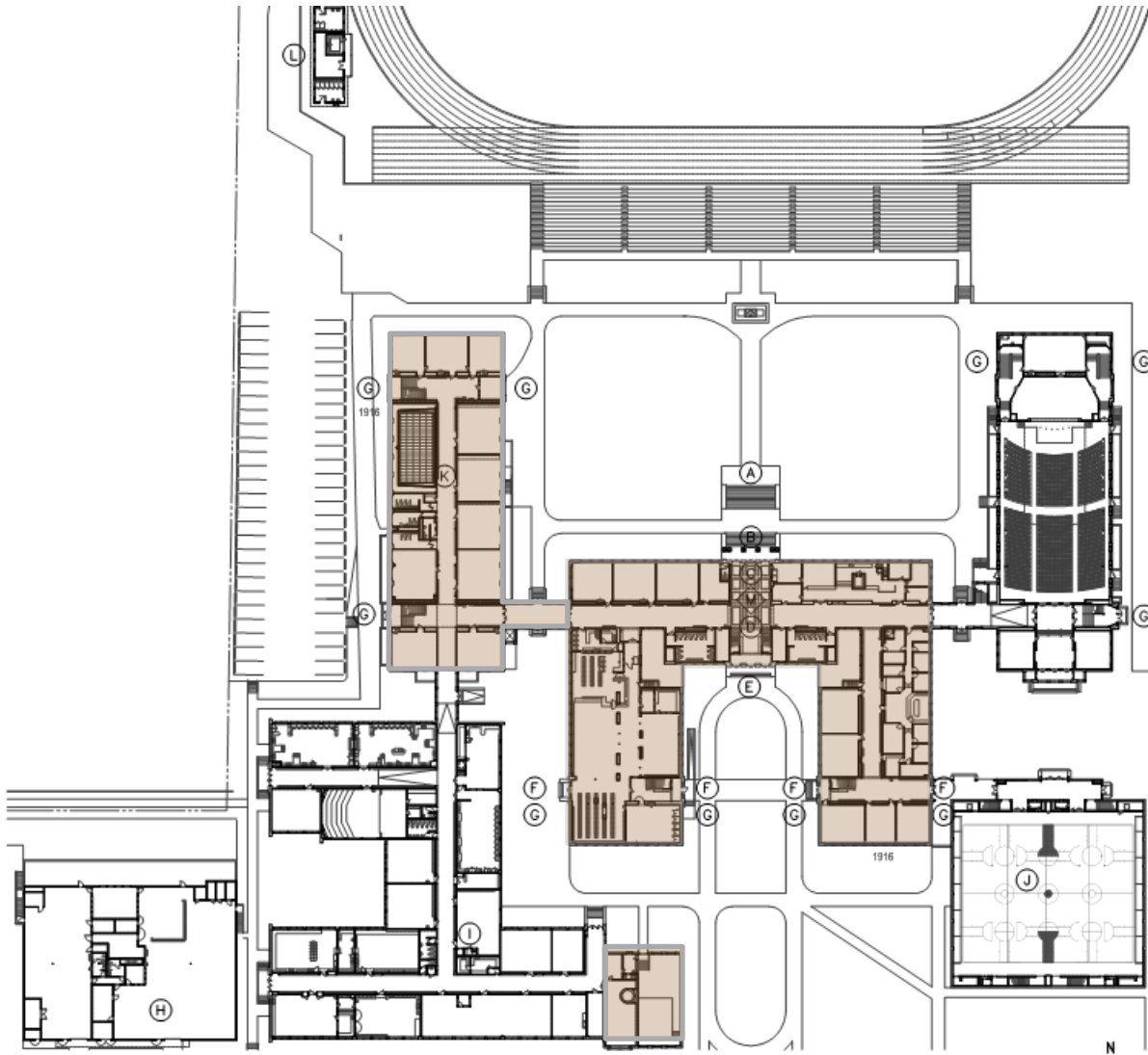

Dull Olson Weekes – IBI Group Architects  
Portland Public Schools – Franklin HS Modernization

21<sup>st</sup> Century Learning in an Historic Building  
September 21, 2013



# FRANKLIN HS CAMPUS – INVENTORY



Dull Olson Weekes – IBI Group Architects  
Portland Public Schools – Franklin HS Modernization

21<sup>st</sup> Century Learning in an Historic Building  
September 21, 2013



# FRANKLIN HS CAMPUS – INVENTORY

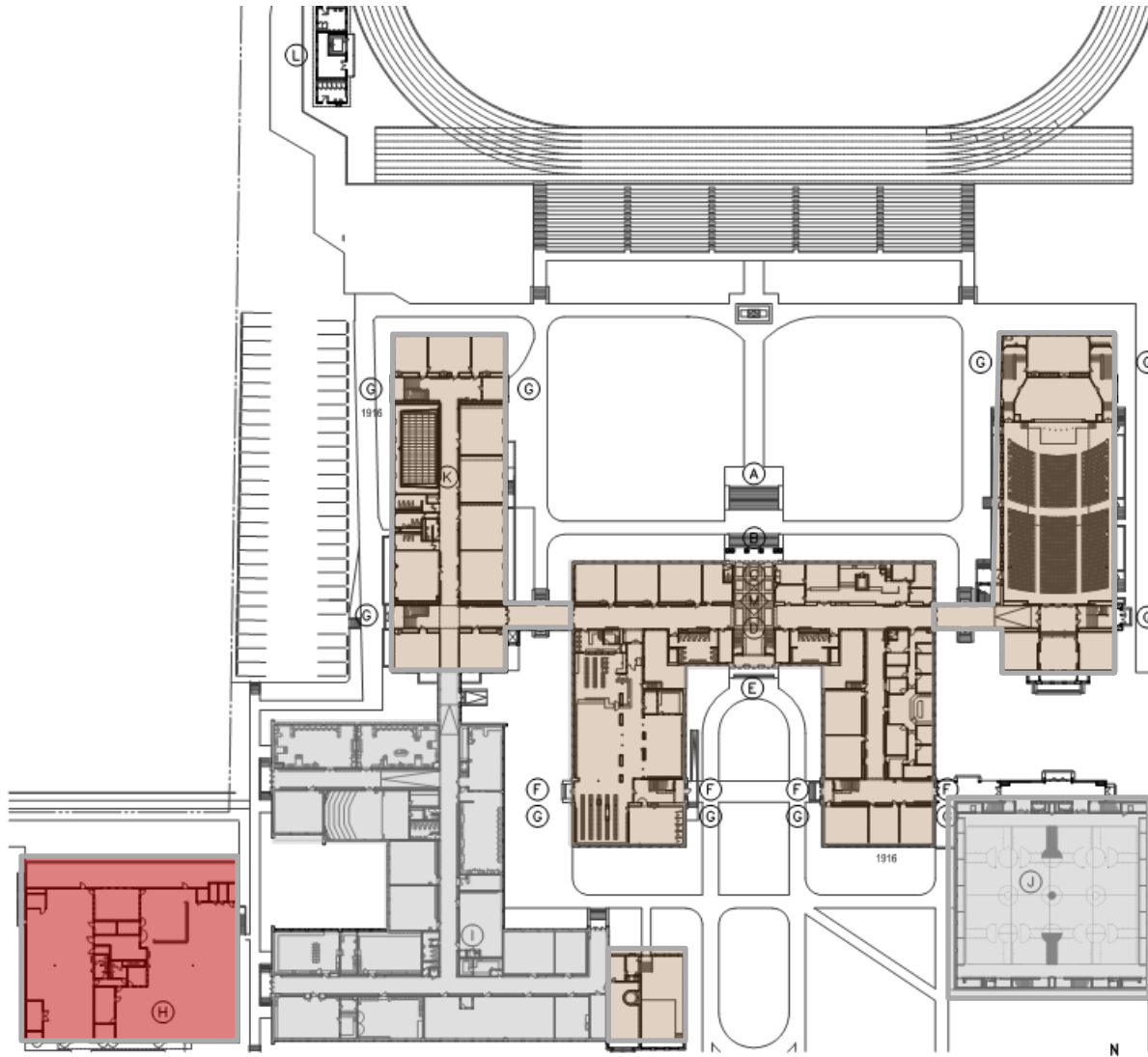

Dull Olson Weekes – IBI Group Architects  
Portland Public Schools – Franklin HS Modernization

21<sup>st</sup> Century Learning in an Historic Building  
September 21, 2013



# FRANKLIN HS CAMPUS – SITE ORGANIZATION

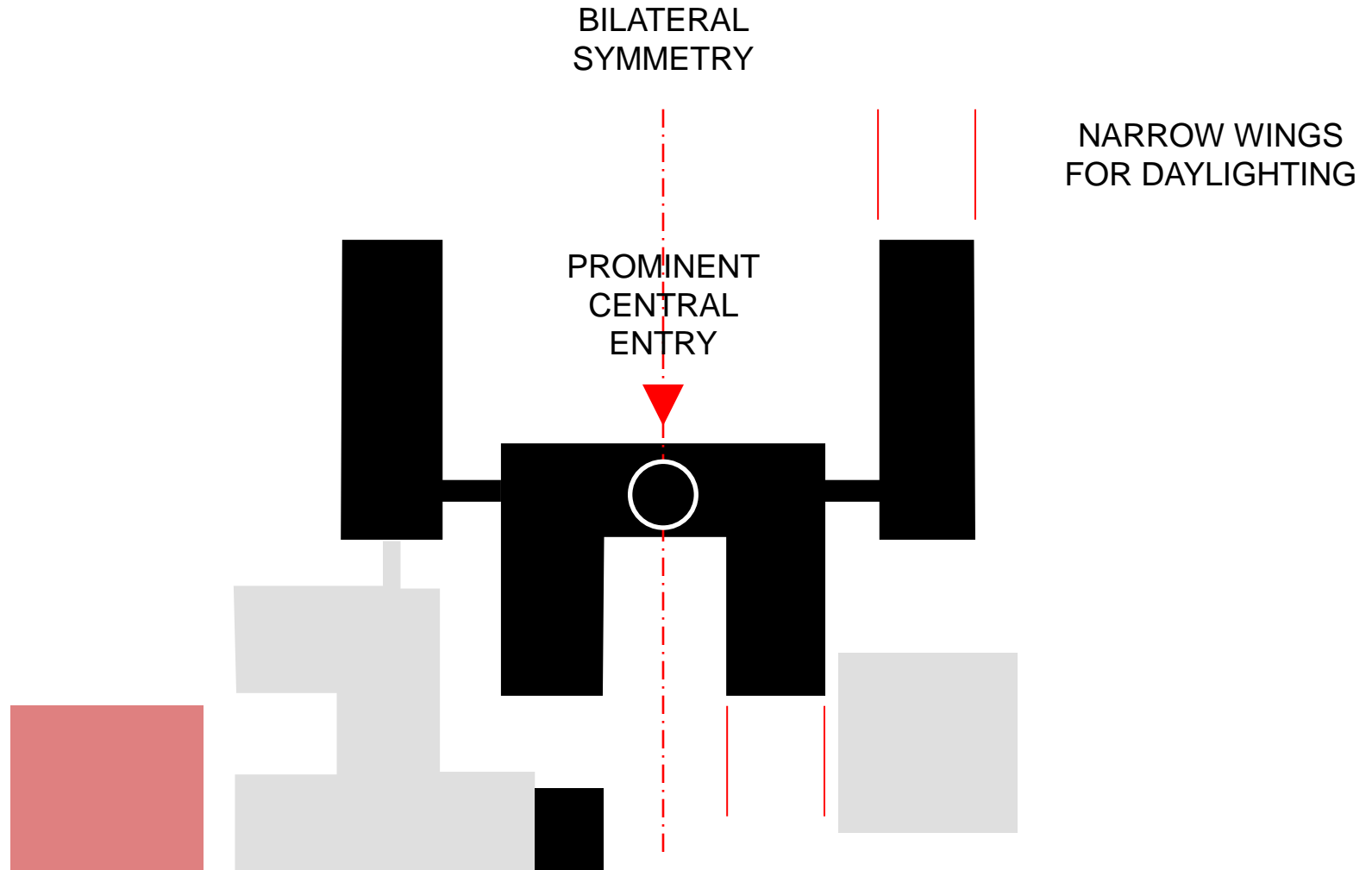

# FRANKLIN HS CAMPUS – DIVISION STREET ENTRY



Dull Olson Weekes – IBI Group Architects  
Portland Public Schools – Franklin HS Modernization

21<sup>st</sup> Century Learning in an Historic Building  
September 21, 2013



# FRANKLIN HS CAMPUS – SITE ORGANIZATION

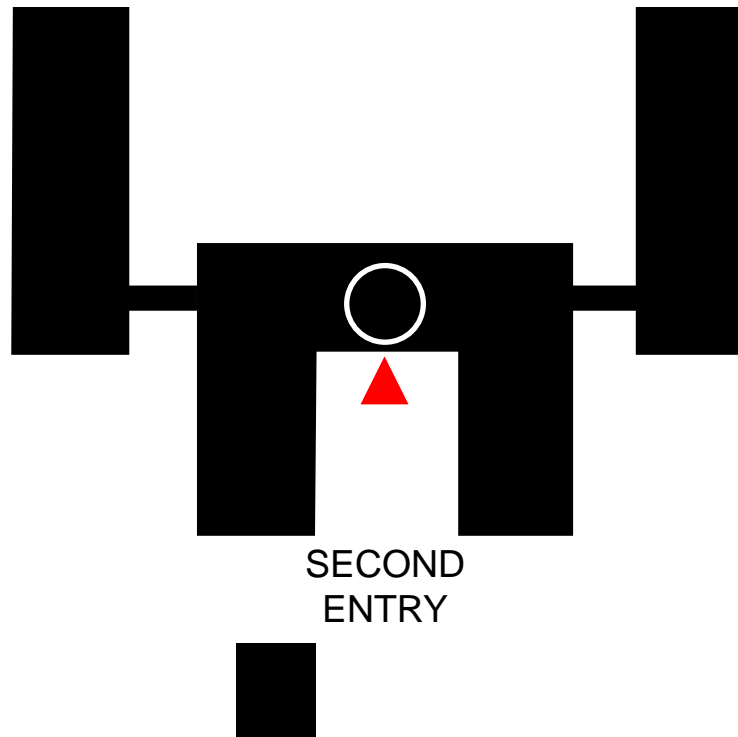

# FRANKLIN HS CAMPUS – WOODWARD STREET ENTRY



**Dull Olson Weekes – IBI Group Architects**  
Portland Public Schools – Franklin HS Modernization

**21<sup>st</sup> Century Learning in an Historic Building**  
September 21, 2013





# FRANKLIN HS CAMPUS – SITE ORGANIZATION

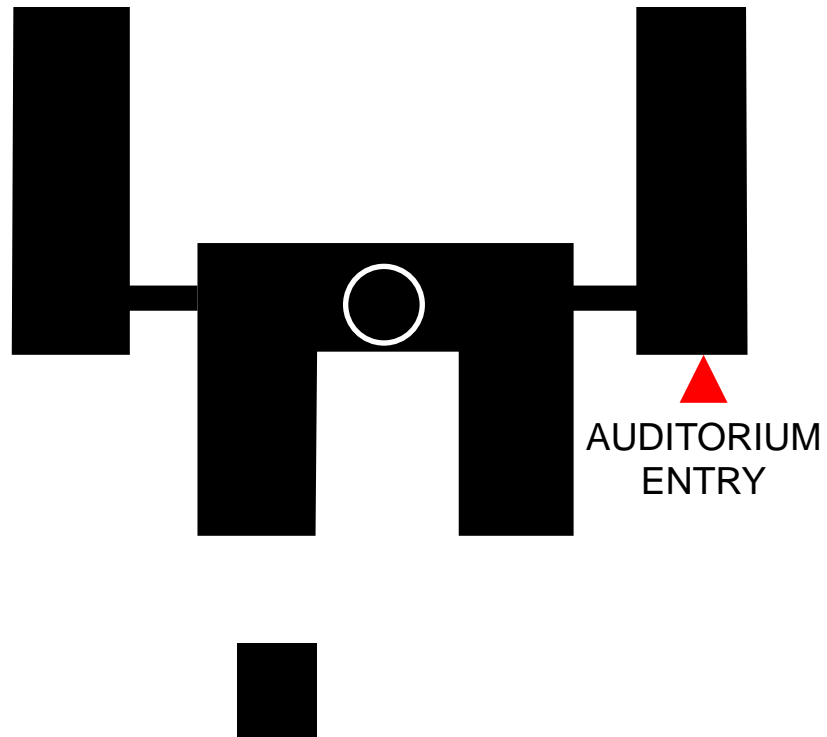

# FRANKLIN HS CAMPUS – AUDITORIUM ENTRY



Dull Olson Weekes – IBI Group Architects  
Portland Public Schools – Franklin HS Modernization

21<sup>st</sup> Century Learning in an Historic Building  
September 21, 2013



# FRANKLIN HS CAMPUS – SITE ORGANIZATION

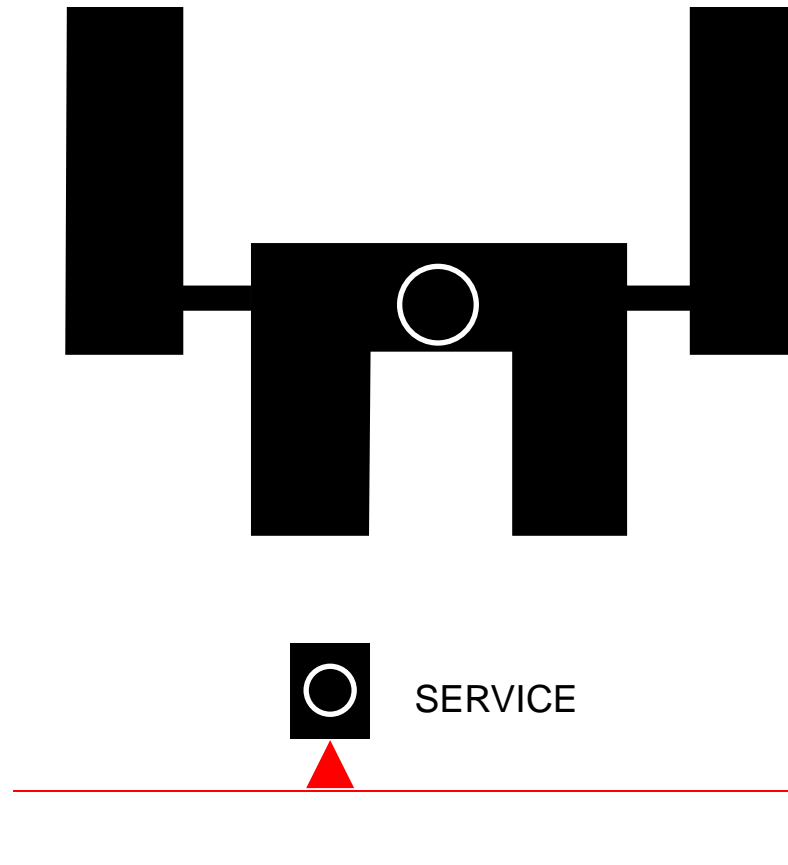

SERVICE



Dull Olson Weekes – IBI Group Architects  
Portland Public Schools – Franklin HS Modernization

21<sup>st</sup> Century Learning in an Historic Building  
September 21, 2013



# FRANKLIN HS CAMPUS – ORIGINAL SITE PLAN

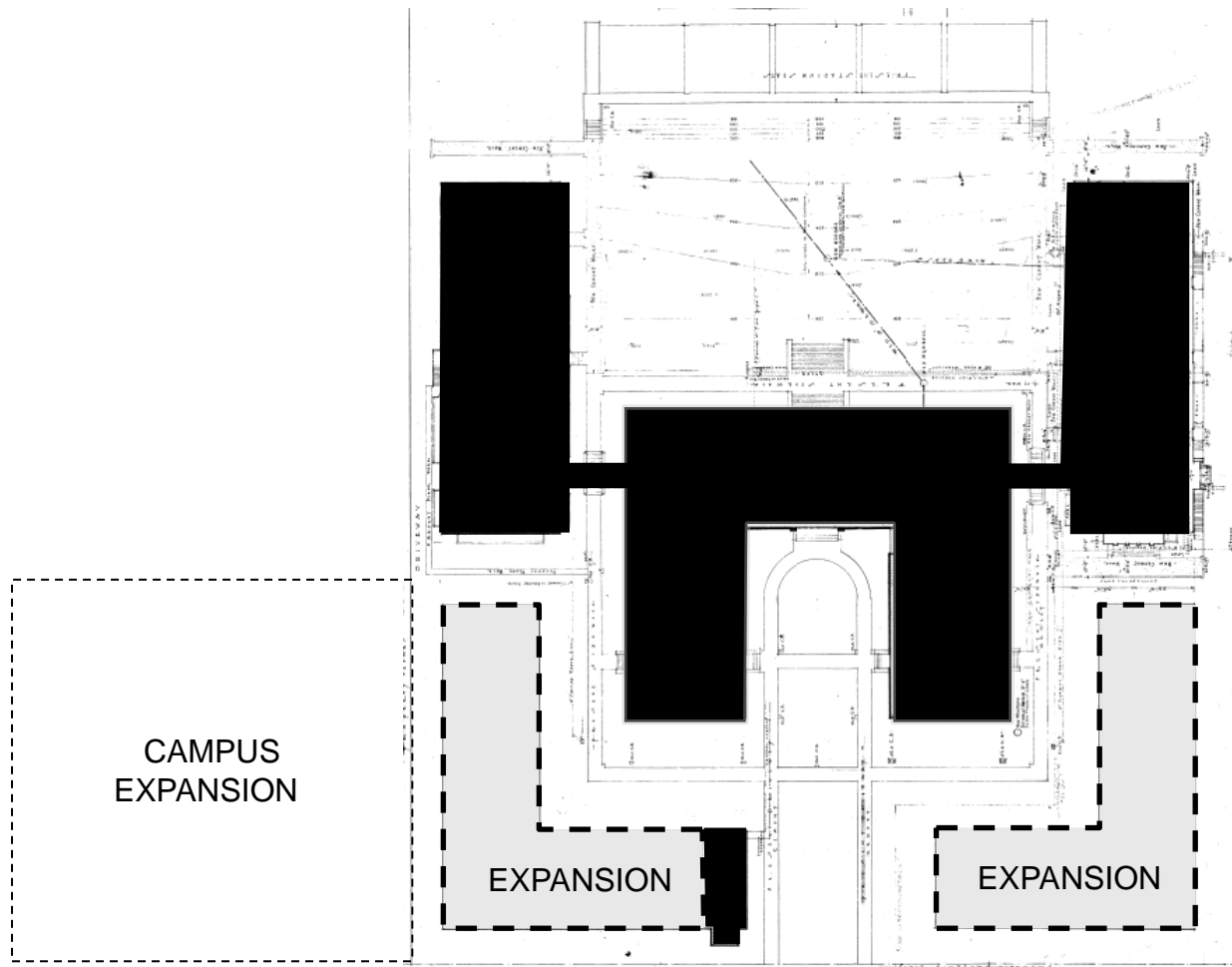

Dull Olson Weekes – IBI Group Architects  
Portland Public Schools – Franklin HS Modernization

21<sup>st</sup> Century Learning in an Historic Building  
September 21, 2013



# FRANKLIN HS INTERIOR – ENTRY AND STAIR

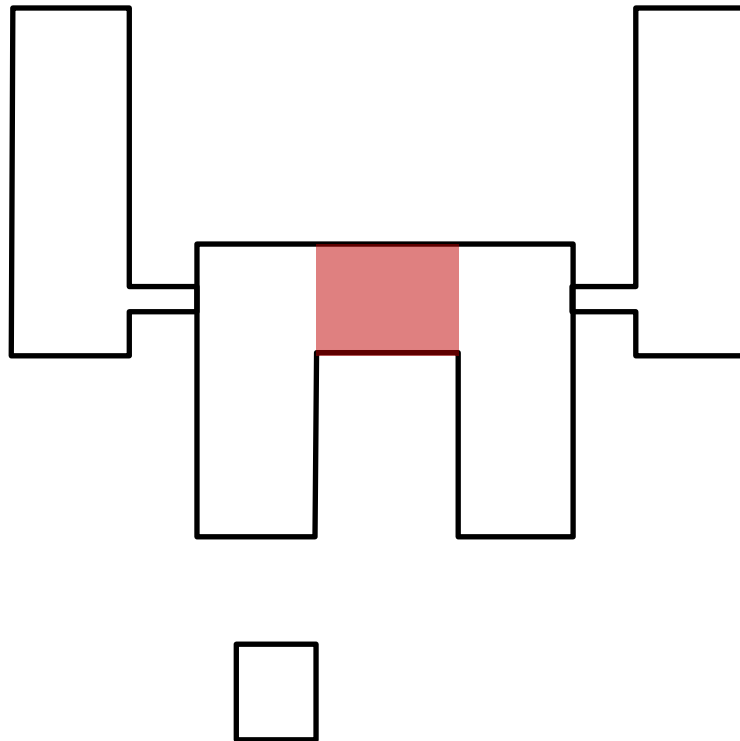

Dull Olson Weekes – IBI Group Architects  
Portland Public Schools – Franklin HS Modernization

21<sup>st</sup> Century Learning in an Historic Building  
September 21, 2013



# FRANKLIN HS INTERIOR – ENTRY AND STAIR



# FRANKLIN HS INTERIOR – ENTRY AND STAIR



# FRANKLIN HS INTERIOR – ENTRY AND STAIR





# FRANKLIN HS INTERIOR – ENTRY AND STAIR

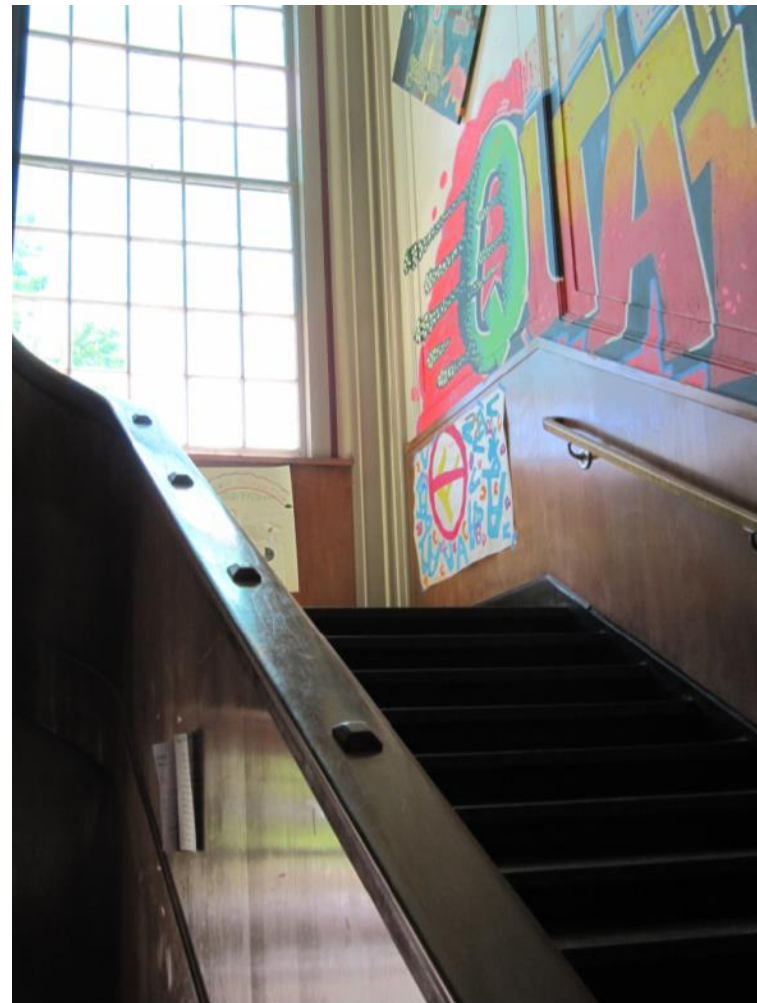

# FRANKLIN HS INTERIOR – AUDITORIUM

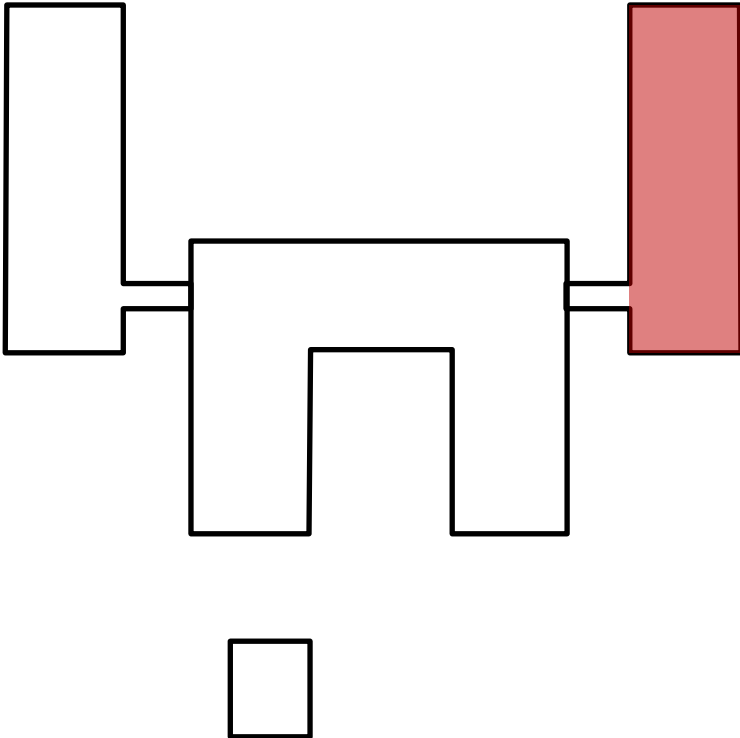

Dull Olson Weekes – IBI Group Architects  
Portland Public Schools – Franklin HS Modernization

21<sup>st</sup> Century Learning in an Historic Building  
September 21, 2013



# FRANKLIN HS INTERIOR – AUDITORIUM



# FRANKLIN HS INTERIOR – AUDITORIUM



Dull Olson Weekes – IBI Group Architects  
Portland Public Schools – Franklin HS Modernization

21<sup>st</sup> Century Learning in an Historic Building  
September 21, 2013



# FRANKLIN HS INTERIOR – AUDITORIUM



# FRANKLIN HS INTERIOR – CAFETERIA



# FRANKLIN HS INTERIOR – CAFETERIA



# FRANKLIN HS INTERIOR – FORMER GYMNASIUM / VOCATIONAL

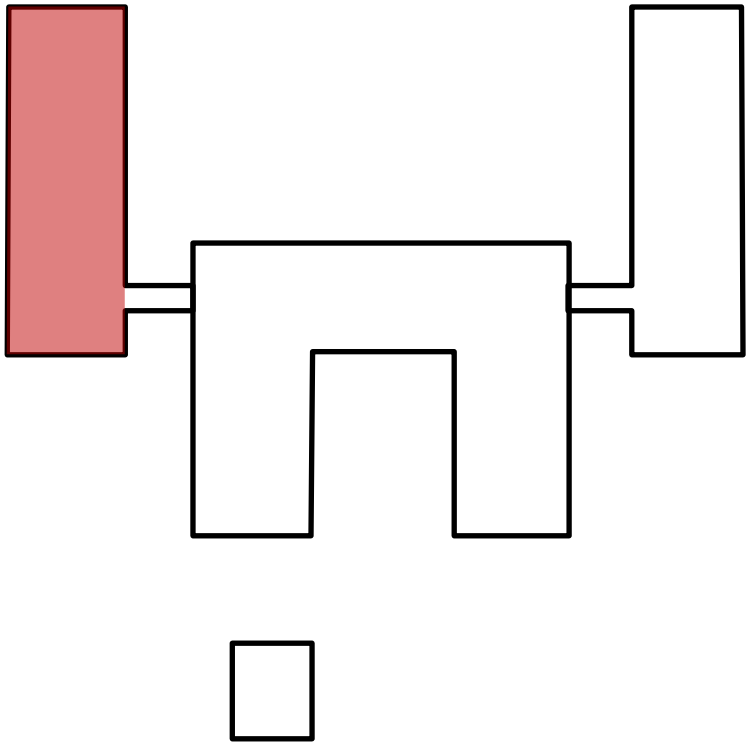

Dull Olson Weekes – IBI Group Architects  
Portland Public Schools – Franklin HS Modernization

21<sup>st</sup> Century Learning in an Historic Building  
September 21, 2013





# FRANKLIN HS INTERIOR – FORMER GYMNASIUM



Dull Olson Weekes – IBI Group Architects  
Portland Public Schools – Franklin HS Modernization

21<sup>st</sup> Century Learning in an Historic Building  
September 21, 2013



# FRANKLIN HS INTERIOR – FORMER GYMNASIUM



Dull Olson Weekes – IBI Group Architects  
Portland Public Schools – Franklin HS Modernization

21<sup>st</sup> Century Learning in an Historic Building  
September 21, 2013



# FRANKLIN HS INTERIOR – CORRIDORS

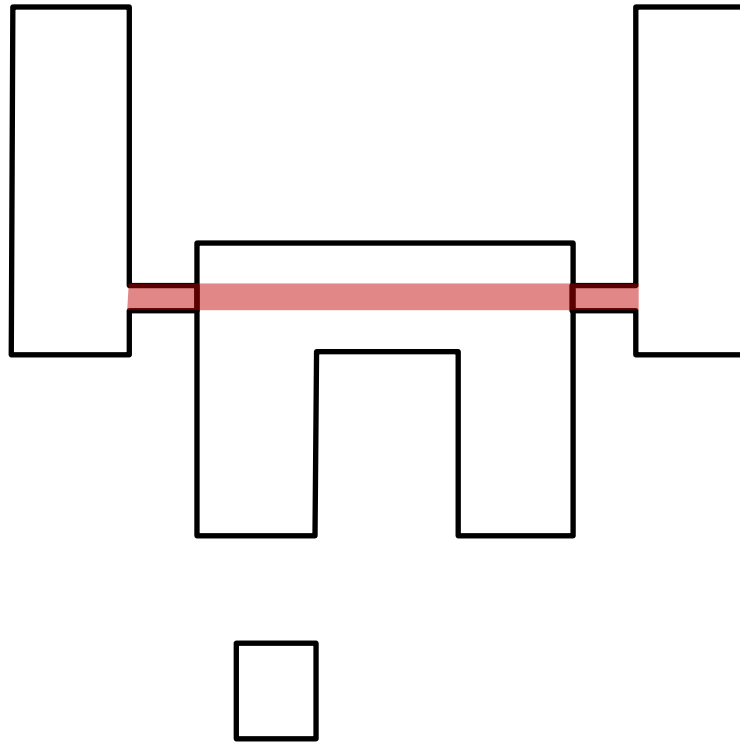

Dull Olson Weekes – IBI Group Architects  
Portland Public Schools – Franklin HS Modernization

21<sup>st</sup> Century Learning in an Historic Building  
September 21, 2013



# FRANKLIN HS INTERIOR – CORRIDORS



Dull Olson Weekes – IBI Group Architects  
Portland Public Schools – Franklin HS Modernization

21<sup>st</sup> Century Learning in an Historic Building  
September 21, 2013



# FRANKLIN HS INTERIOR – CORRIDORS



Dull Olson Weekes – IBI Group Architects  
Portland Public Schools – Franklin HS Modernization

21<sup>st</sup> Century Learning in an Historic Building  
September 21, 2013



# FRANKLIN HS INTERIOR – ENTRY AND STAIR



# FRANKLIN HS INTERIOR – CORRIDORS



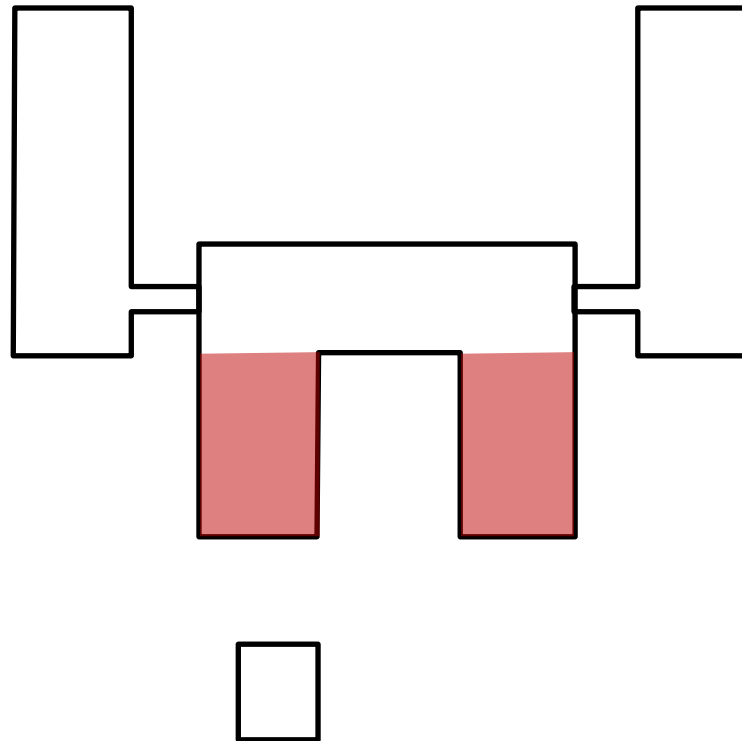



# FRANKLIN HS INTERIOR – CORRIDORS



# FRANKLIN HS INTERIOR – CORRIDORS



Dull Olson Weekes – IBI Group Architects  
Portland Public Schools – Franklin HS Modernization

21<sup>st</sup> Century Learning in an Historic Building  
September 21, 2013



# CULTURALLY SIGNIFICANT ELEMENT PRIORITIZATION

- ① North Lawn
- ② South Courtyard
- ③ Lobby
- ④ Stair
- ⑤ Benji Sculpture
- ⑥ Auditorium
- ⑦ Auditorium Entry
- ⑧ Cafeteria
- ⑨ Fieldhouse
- ⑩ Gymnasium
- ⑪ Classrooms [1951]
- ⑫ Boiler Room
- ⑬ Shop Building

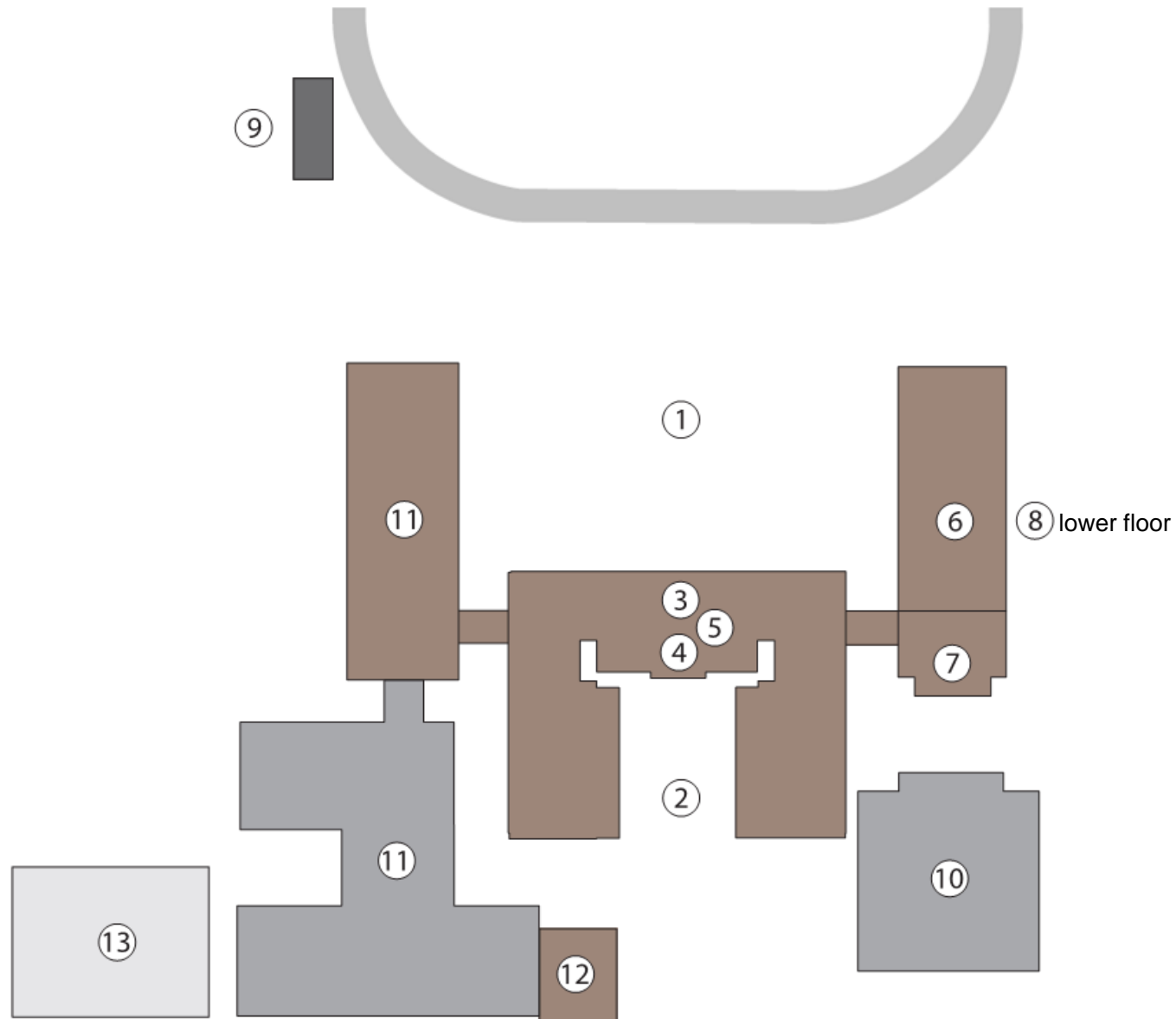



Dull Olson Weekes – IBI Group Architects  
Portland Public Schools – Franklin HS Modernization

21<sup>st</sup> Century Learning in an Historic Building  
September 21, 2013



# 21<sup>ST</sup> CENTURY LEARNING SPACES – LEARNING NEIGHBORHOODS

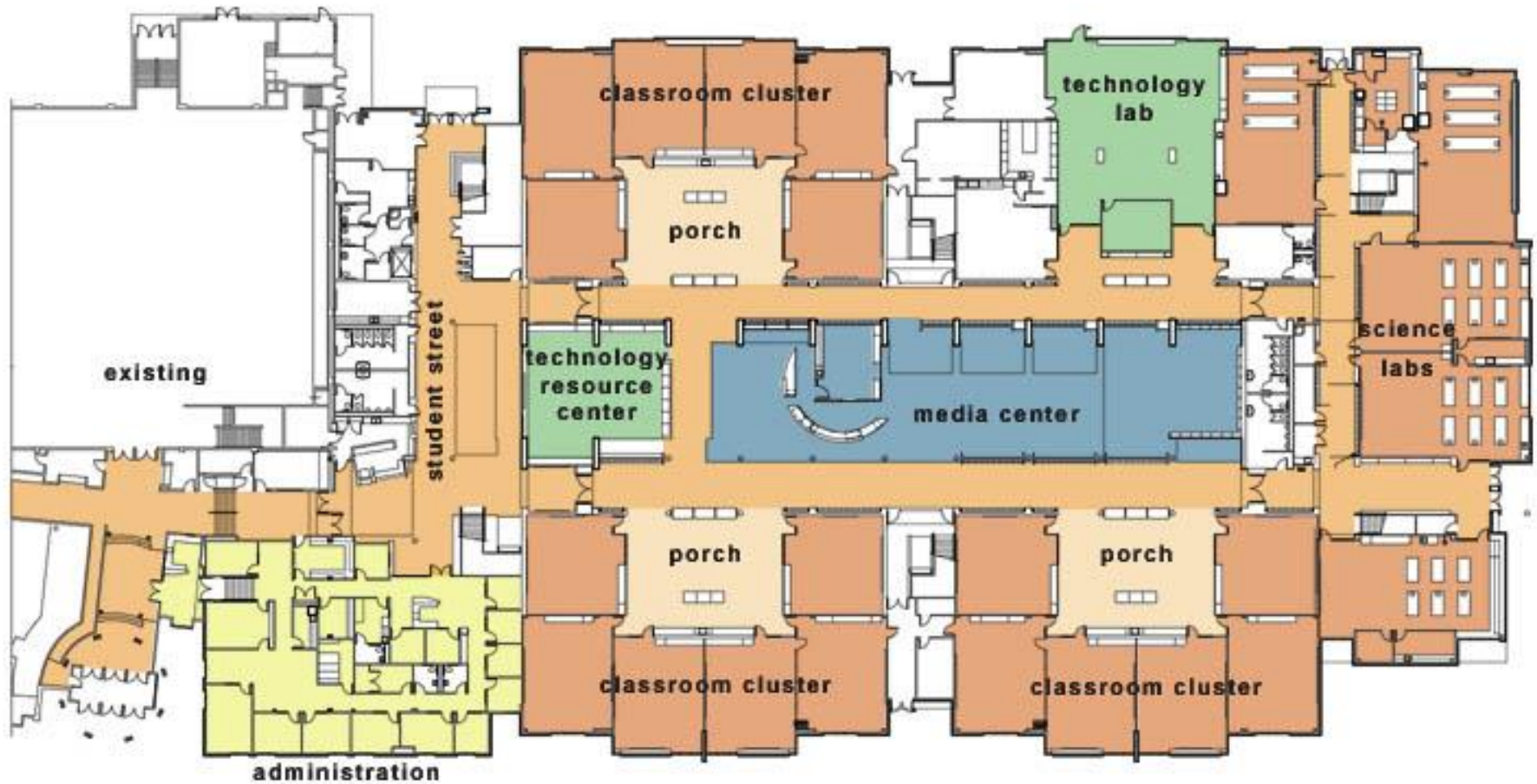

# 21<sup>ST</sup> CENTURY LEARNING SPACES – INNOVATIVE CLASSROOMS

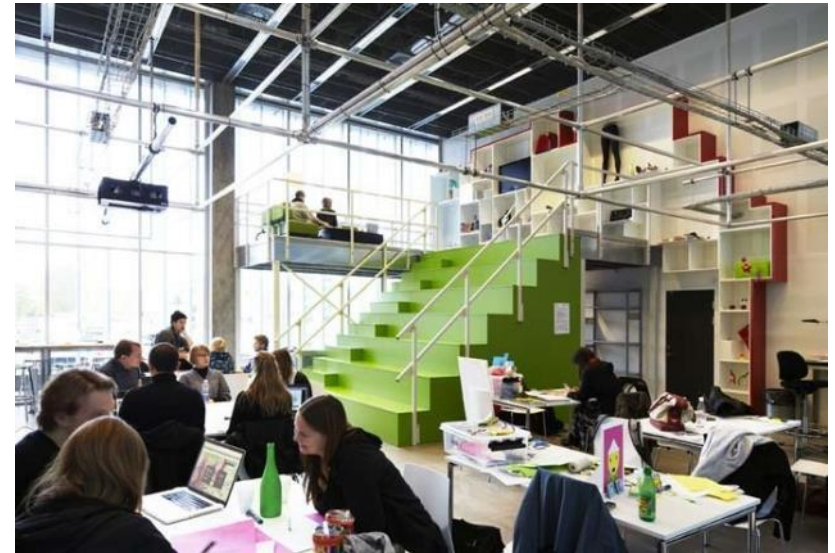

# 21<sup>ST</sup> CENTURY LEARNING SPACES – GROUP WORK



Dull Olson Weekes – IBI Group Architects  
Portland Public Schools – Franklin HS Modernization

21<sup>st</sup> Century Learning in an Historic Building  
September 21, 2013



# 21<sup>ST</sup> CENTURY LEARNING SPACES – INNOVATIVE LEARNING PLACES

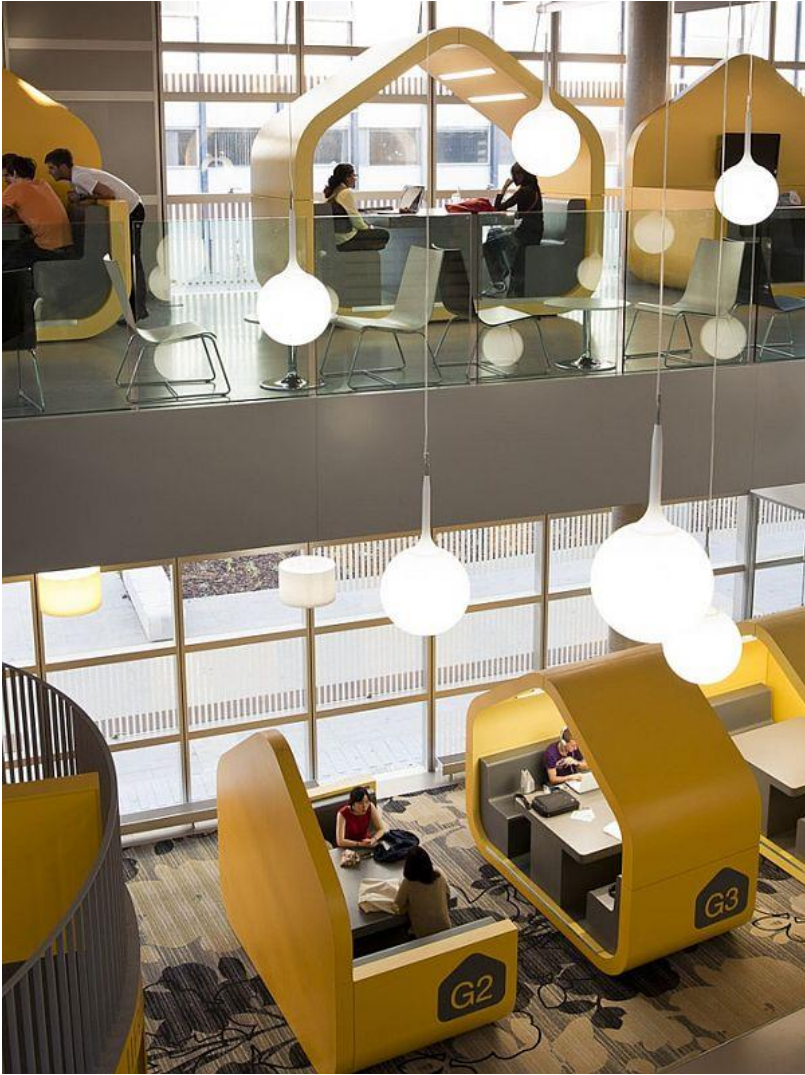

Dull Olson Weekes – IBI Group Architects  
Portland Public Schools – Franklin HS Modernization

21<sup>st</sup> Century Learning in an Historic Building  
September 21, 2013





# 21<sup>ST</sup> CENTURY LEARNING SPACES – DAYLIGHTING IN LEARNING SPACES



# 21<sup>ST</sup> CENTURY LEARNING SPACES – DAYLIGHTING

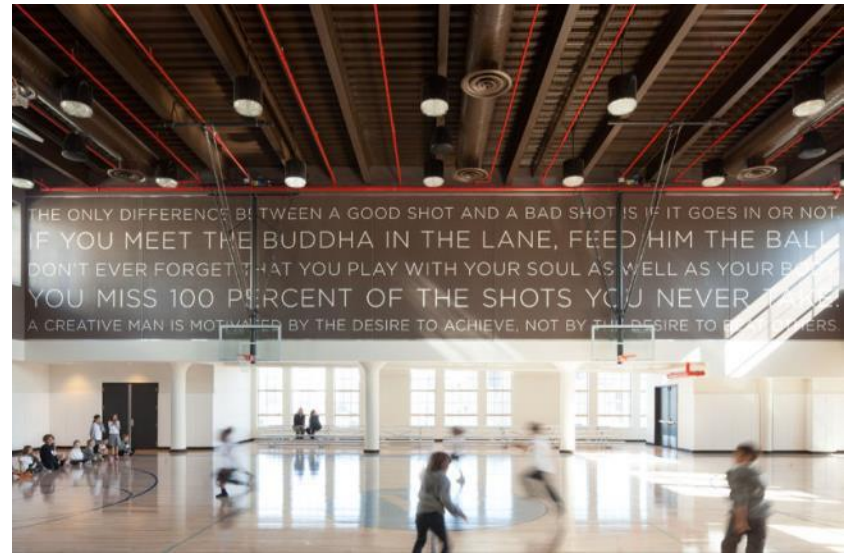

Dull Olson Weekes – IBI Group Architects  
Portland Public Schools – Franklin HS Modernization

21<sup>st</sup> Century Learning in an Historic Building  
September 21, 2013



# 21<sup>ST</sup> CENTURY LEARNING SPACES – DAYLIGHTING / CAFE



Dull Olson Weekes – IBI Group Architects  
Portland Public Schools – Franklin HS Modernization

21<sup>st</sup> Century Learning in an Historic Building  
September 21, 2013



# 21<sup>ST</sup> CENTURY LEARNING SPACES – VERTICAL CONNECTION

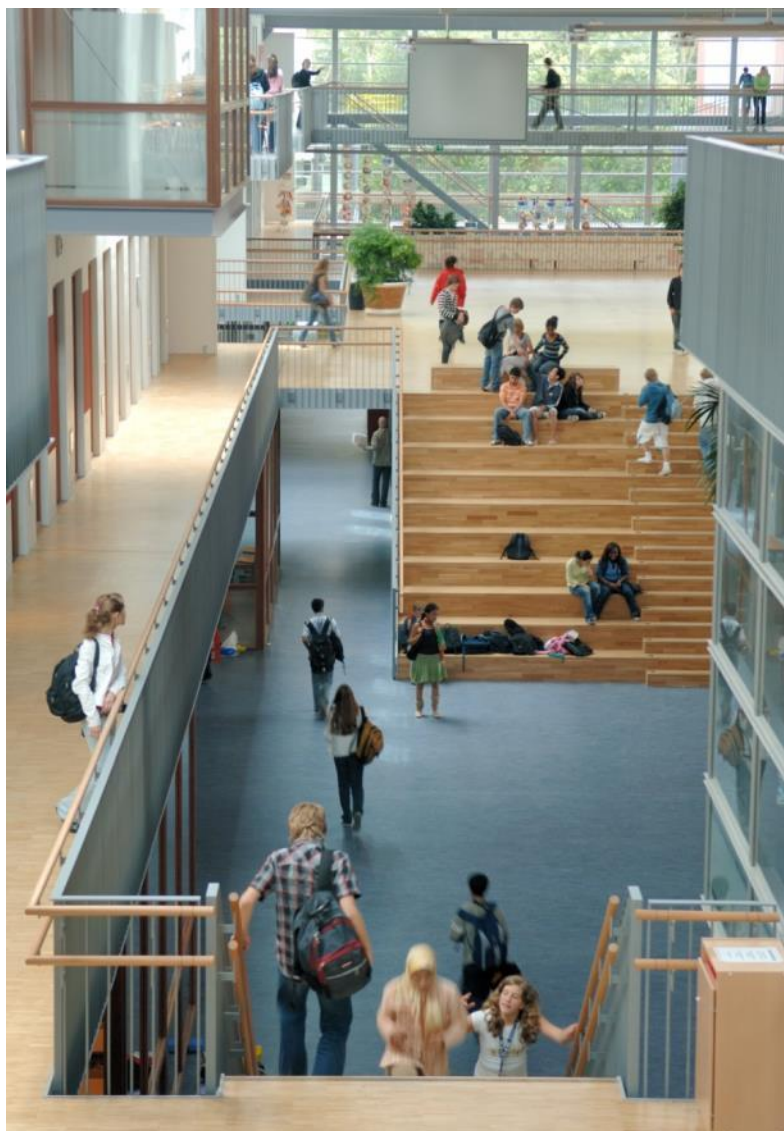

# 21<sup>ST</sup> CENTURY LEARNING SPACES – CONNECTION TO OUTDOORS



Dull Olson Weekes – IBI Group Architects  
Portland Public Schools – Franklin HS Modernization

21<sup>st</sup> Century Learning in an Historic Building  
September 21, 2013



# 21<sup>ST</sup> CENTURY LEARNING SPACES – HONORING THE PAST



Dull Olson Weekes – IBI Group Architects  
Portland Public Schools – Franklin HS Modernization

21<sup>st</sup> Century Learning in an Historic Building  
September 21, 2013



# 21<sup>ST</sup> CENTURY LEARNING SPACES - MODERNIZATION



Dull Olson Weekes – IBI Group Architects  
Portland Public Schools – Franklin HS Modernization

21<sup>st</sup> Century Learning in an Historic Building  
September 21, 2013



# FRANKLIN HS – CIRCULATION

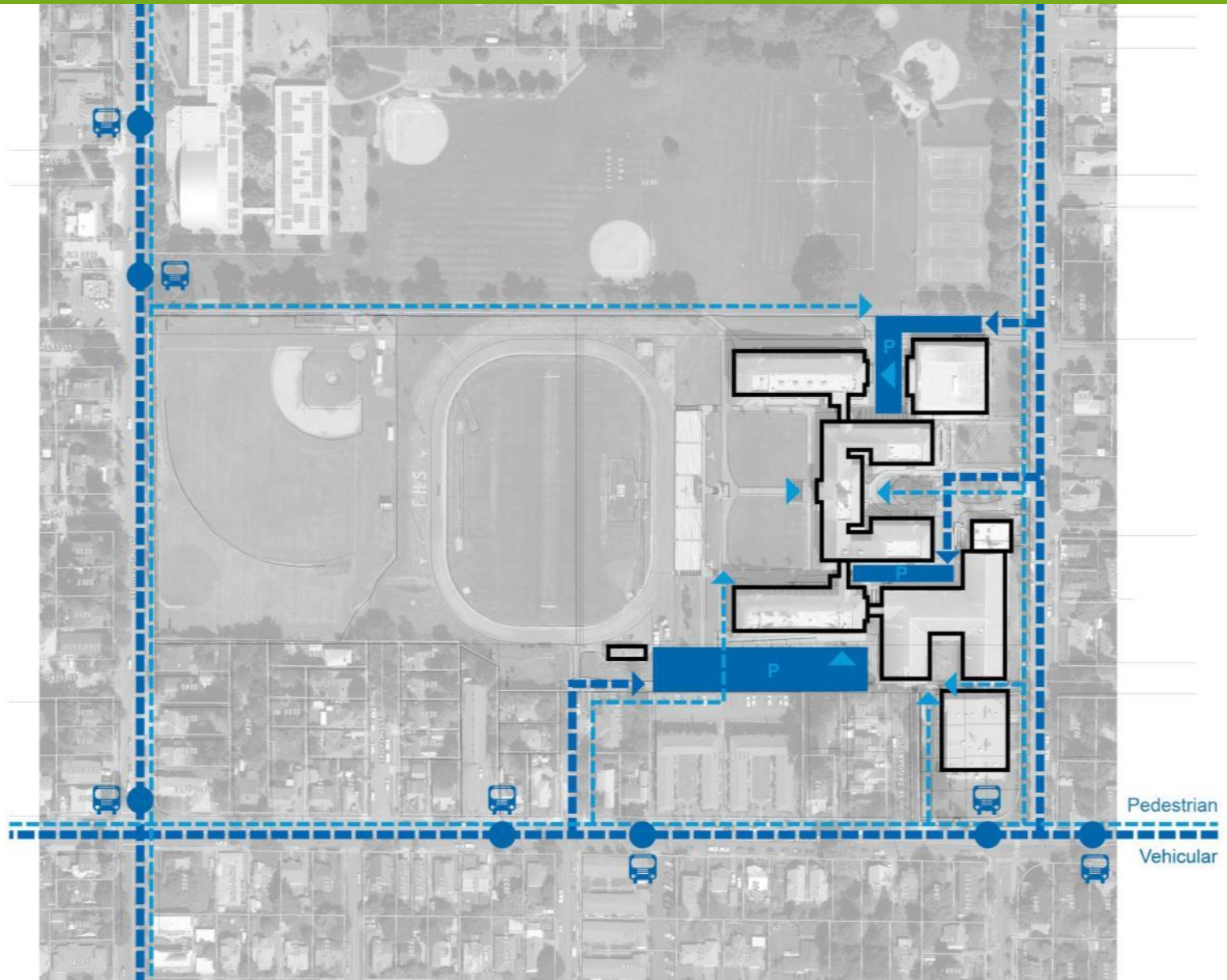



# FRANKLIN HS – VIEW POTENTIAL

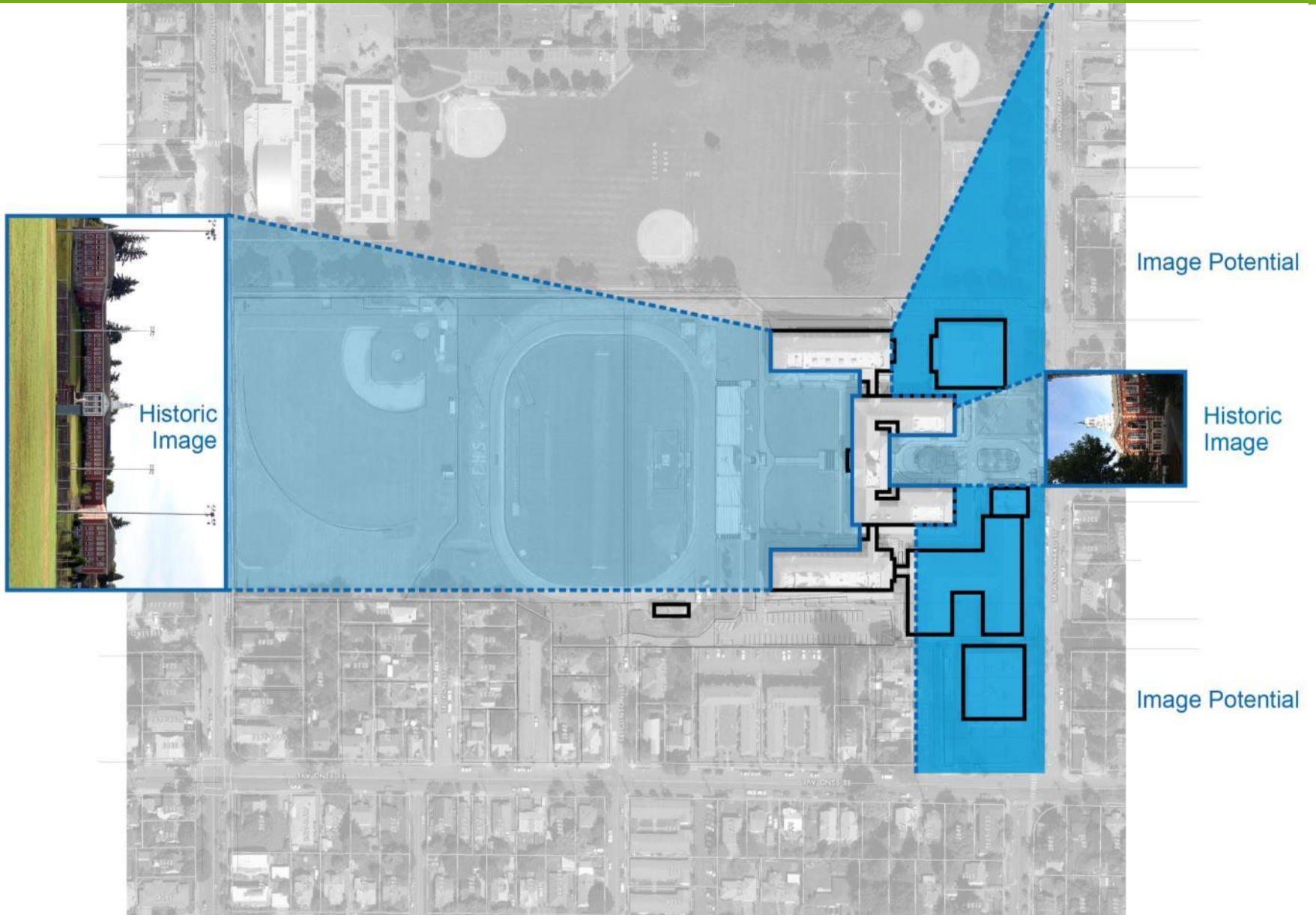

# FRANKLIN HS – SUN AND WIND

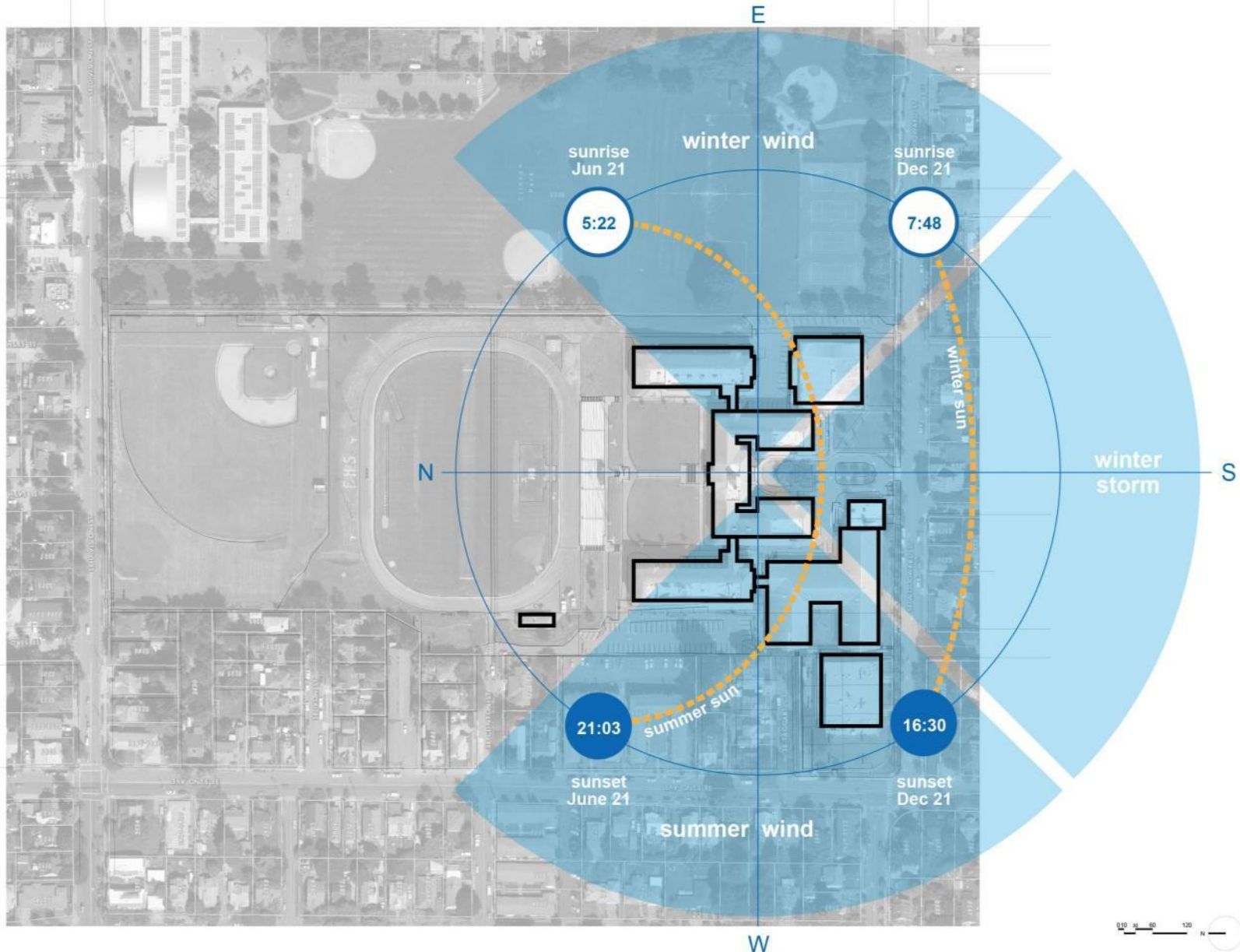

# FRANKLIN HS – MASTER PLAN OPTIONS

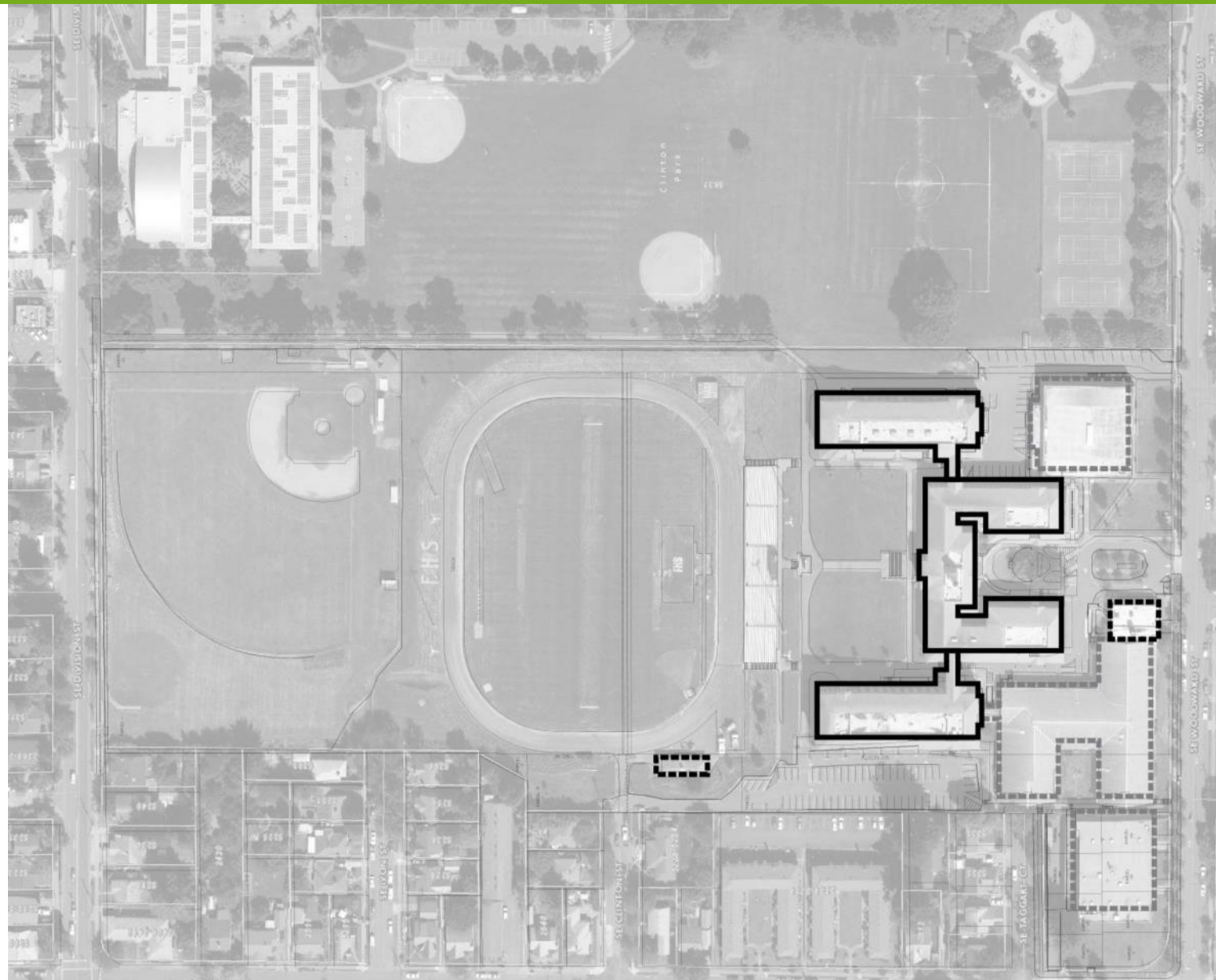

**Dull Olson Weekes – IBI Group Architects**  
Portland Public Schools – Franklin HS Modernization

**21<sup>st</sup> Century Learning in an Historic Building**  
September 21, 2013



# FRANKLIN HS – PROGRAM SUMMARY

|   | Approx.<br>Net Area | Approx.<br>Gross Area |
|---|---------------------|-----------------------|
| <b>Core Classrooms A – English / Health</b>         | <b>16,500</b>       | <b>21,500</b>         |
| <b>Core Classrooms B – Social Stud / World Lang</b> | <b>17,500</b>       | <b>22,500</b>         |
| <b>STEM – Science &amp; Math</b>                    | <b>22,000</b>       | <b>29,000</b>         |
| <b>STEM – CTE</b>                                   | <b>7,000</b>        | <b>9,000</b>          |
| <b>Fine &amp; Performing Arts</b>                   | <b>34,000</b>       | <b>44,000</b>         |
| <b>Athletics – Locker Rooms and Support</b>         | <b>12,000</b>       | <b>16,000</b>         |
| <b>Athletics – Gyms and Athletic Rooms</b>          | <b>36,000</b>       | <b>47,000</b>         |
| <b>Administration &amp; Counseling</b>              | <b>11,000</b>       | <b>14,000</b>         |
| <b>Media Center / Library</b>                       | <b>11,500</b>       | <b>15,000</b>         |
| <b>Student Center / Commons</b>                     | <b>17,000</b>       | <b>23,000</b>         |
| <b>Partners / Wrap-Around Services</b>              | <b>7,500</b>        | <b>9,000</b>          |
| <b>Approx. Total</b>                                |                     | <b>250,000</b>        |

